

PRECISION CURRENT SHUNT

NSE1500, NSE2000

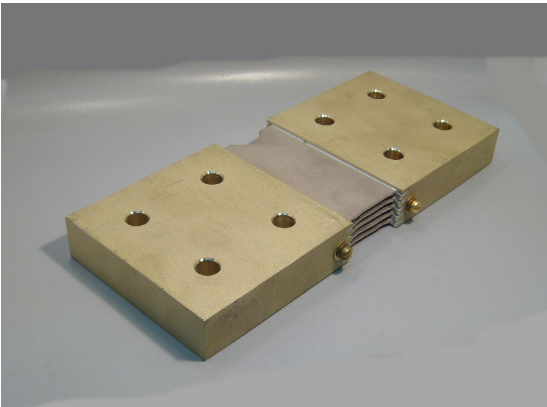

Features and Applications

- Large current shunt for ampere-meters, designed for power electric equipment.
- Excellent long-term stability, low emf and low TCR.
- Easy current measurement is performed by attaching to current bus directory and connecting to ampere-meter through flexible wires.
- All of shunts are calibrated on equipment with current certifications traceable to US-N.I.S.T
- For high precision power supply, EV charger, power converters, and current measurement instruments.

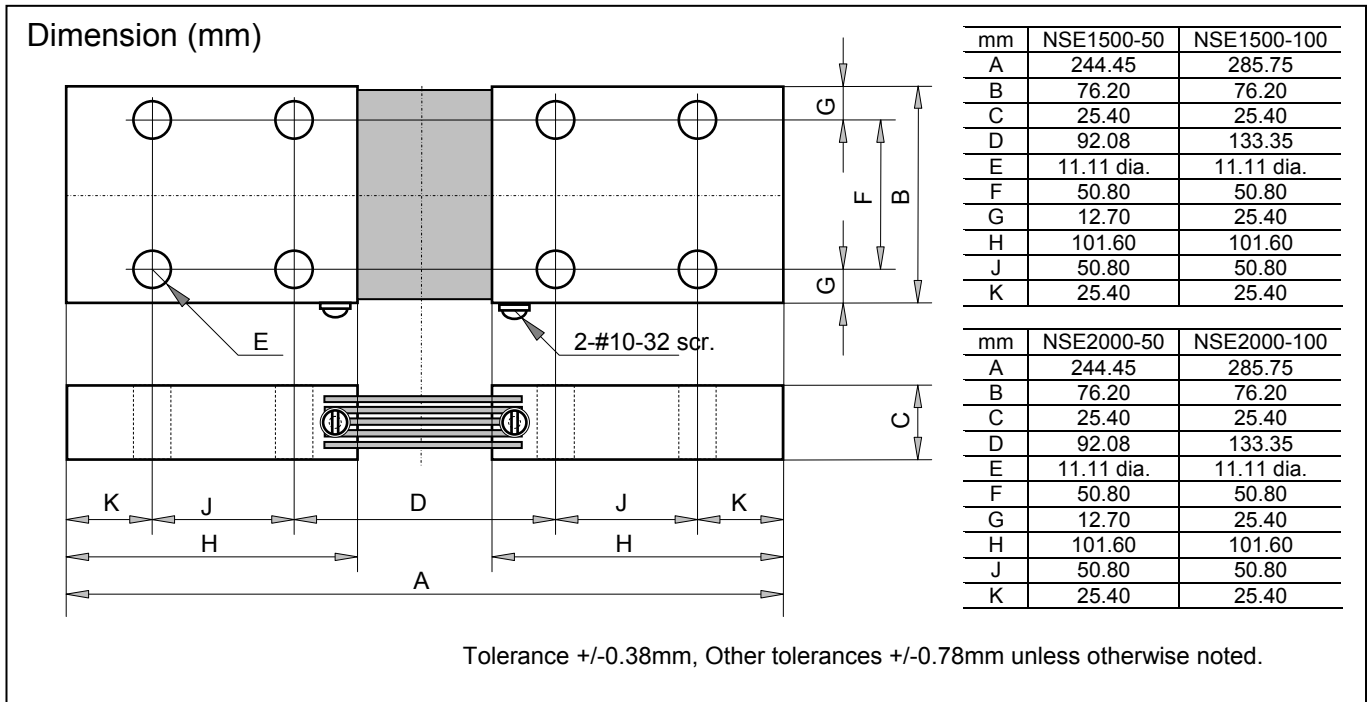

Ordering Information

Style NSE	Rated Current in A 1500	Voltage in mV -50mV	Tolerance C	Code Z00
NSE	1500 2000	-50mV (-60) option -100mV	C(+/-0.25%) (1)	Z00

- (1) Accuracy will be assure B(+/-0.1%) in option.
- (2) Recommended operation current shall be decreased 2/3 of their rated current.

PRECISION CURRENT SHUNT NSE1500, NSE2000

Specification and Performance

	NSE1500-50mV	NSE1500-100mV	NSE2000-50mV	NSE2000-100mV
Rated Current (A)	1500A	1500A	2000A	2000A
Operating Current (A)	1000A	1000A	1330A	1330A
Rated Output (mV)	50mV (60mV option)	100mV	50mV (60mV option)	100mV
Eq. Resistance(milliohms)	---	---	---	---
Voltage Tolerance (%)	Resistance is based on the amperage and millivolt rating, nominal resistance is calculated using Ohms law.			
Operating Temp. (deg C)	+/-0.25%(C)			
Strage Temp. (deg C)	+30 to +70 deg C measured at center of Manganin strips			
Weight (Kg)	-55 to +80 deg C			

The way to reduce the operating temperature, such as forced air, increasing physical size, adding heat sink to the blocks, designing for water cooling, and etc.

	milliohms
NSE1500-50mV	0.03333
NSE1500-100mV	0.06667
	milliohms
NSE2000-50mV	0.02500
NSE2000-100mV	0.05000

Resistance (milliohm) calculated from the V-I characteristic.

Thickness (mm)	Width (mm)	Current (A) at 30 deg C Temp. Rise	Current (A) at 65 deg C temp. Rise
3	25	230	362
4	25	290	456
4	50	510	802
5	25	340	535
5	50	610	960
6	25	380	598
6	30	430	675
6	40	550	865
6	50	680	1070
6	75	940	1479
6	100	1200	1888
6	125	1440	2265
6	150	1680	2643
8	50	800	1258
8	75	1100	1730
8	100	1400	2202
8	125	1650	2595
8	150	1930	3036
10	50	880	1384
10	75	1220	1919
10	100	1540	2422

Applications

Current capacity of copper bus bar, JSIA

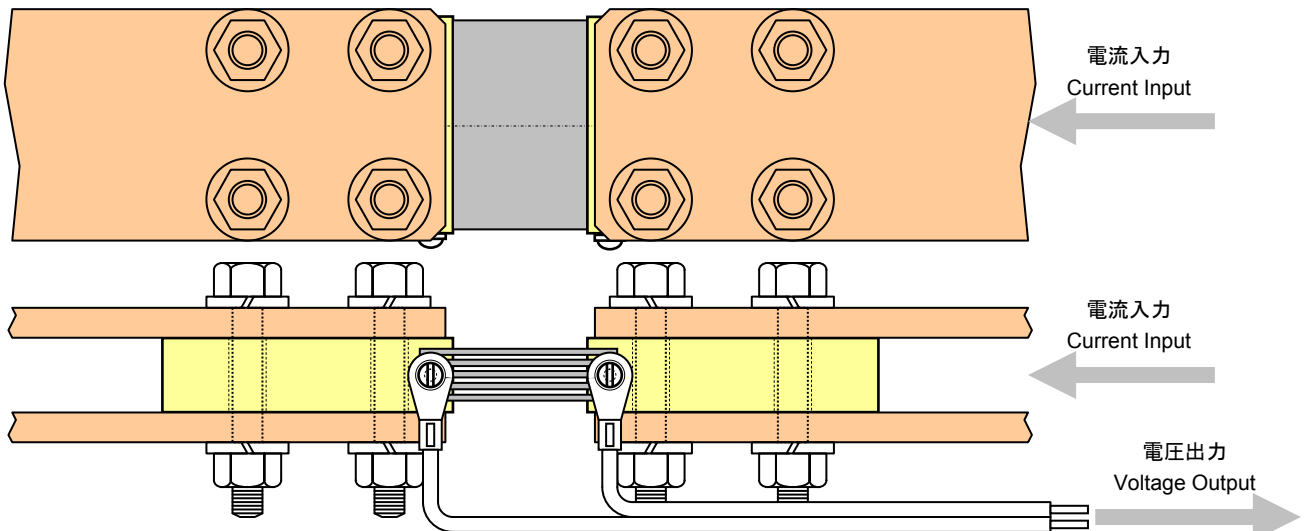

20111201